

BY-LAW NUMBER 2006/08

BY-LAW NO. 2006/08 is a by-law of the County of Wetaskiwin No. 10 in the Province of Alberta, for the purpose of a Text Amendment to the Area Structure Plan in NE 14-46-1-W5M.

WHEREAS: Section 191 of the Municipal Government Act, 2000, Chapter M-26, allows for the amendments of by-laws.

AND WHEREAS: notification and procedural requirements outlined in Section 230 and 606 of the Municipal Government Act, 2000, Chapter M-26 have been met.

NOW THEREFORE: The Council of the County of Wetaskiwin No. 10, hereby enacts as follows:

1. By-law 2001/56 & 2005/21 - NE 14-46-1-W5M (Norris) is amended by deleting the last paragraph of Section B of the Areas Structure Plan as approved by By-law 2001/56 and amended by By-law 2005/21.

Delete the following:

"It is expected that much of the remainder of NE 14-46-1-W5M will eventually be developed for residential lots. As these lots are developed, it will be necessary to have road continuity for emergency vehicles and for connections to adjacent properties. Access to NW 14 will be provided as shown in the Tentative Plan attached, or at such other location as is approved by the County. Access to SE 14 will be provided from the existing road, along the east side of Lot 1 as proposed by Subdivision Application RW/04/61, and thence to the quarter line. The maps in the Area Structure Plan adopted by Council in 2001 and amended in 2006 are amended to show these connections, and by deleting the work "optional."

and in its place substitute the following:

"It is expected that much of the remainder of Section 14 will eventually be developed for residential lots, and it is important to provide road continuity for emergency vehicles. Connections west into NW 14 and south into SE 14 will be provided as shown on drawing 2006, "Map A", which over-rides the map in the area structure plan adopted by Bylaws 2001/56 and 2005/21. In addition, the following wording is added to "Map A" which also becomes part of the amended Area Structure Plan "Locations of roads connecting to other quarters are generalized, and will be determined at subdivision stage"

"The road connecting to SE 14 must be dedicated as a condition of any future subdivision of NE 14. Construction of that road may be delayed until lots are subdivided west of the creek in SE 14. The cost of construction will fall on whichever landowner first needs the road.

"A pedestrian trail system shall be incorporated into the Paul Norris Area Structure Plan."

2. This By-law comes into effect on the date of third and final reading.

READ: A First time this 6th day of April A.D., 2006.

READ: A Second time this 6th day of April, A.D., 2006.

READ: A Third time and finally passed this 6th day of April, A.D., 2006.



REEVE

SECRETARY-TREASURER

County of Wetaskiwin

Bylaw 2006/08

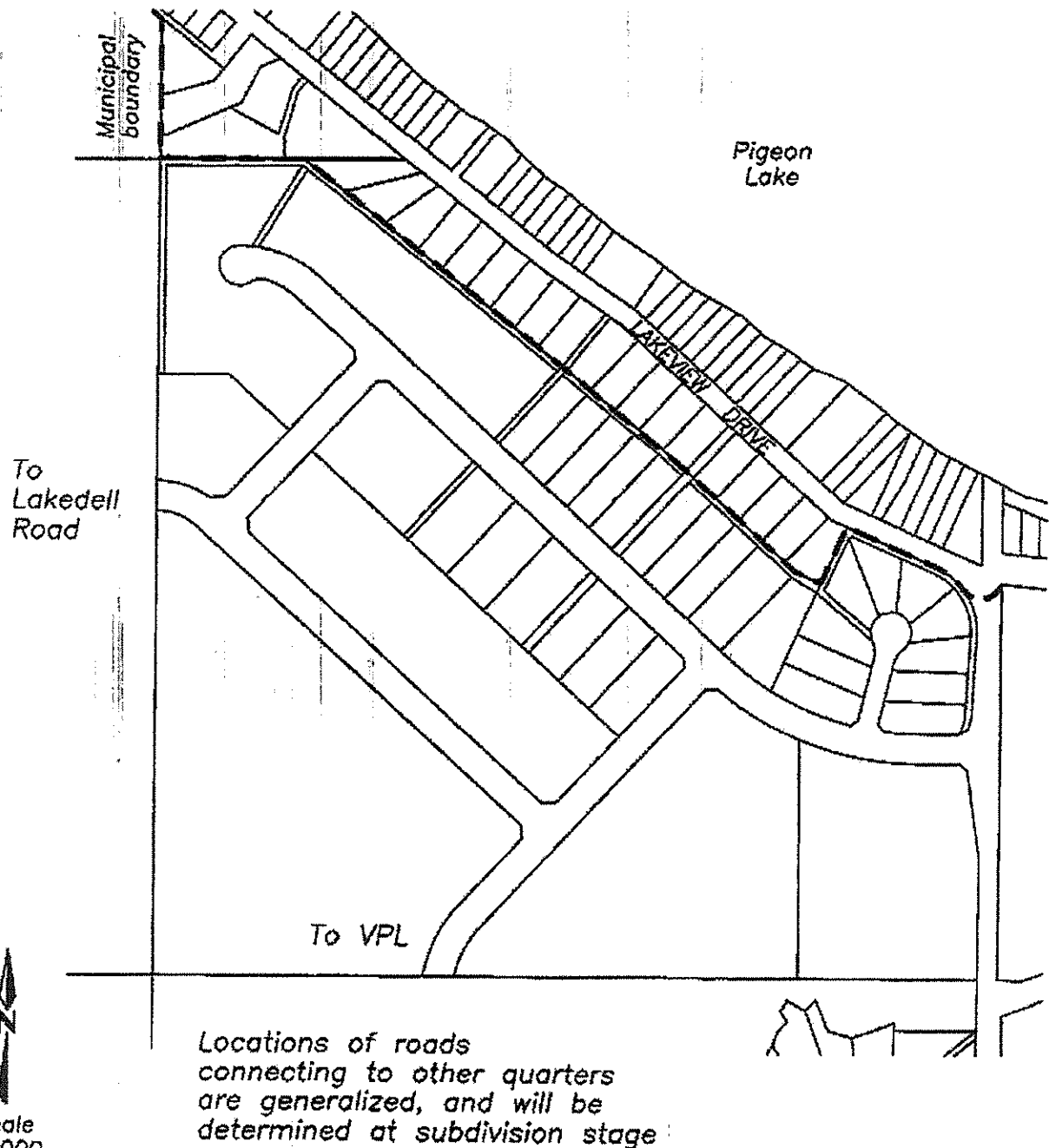
NW 14-46-1-5



Proposed Changes to Norris ASP "MAP A"

C:\dwg2006\rw\norris_asp